

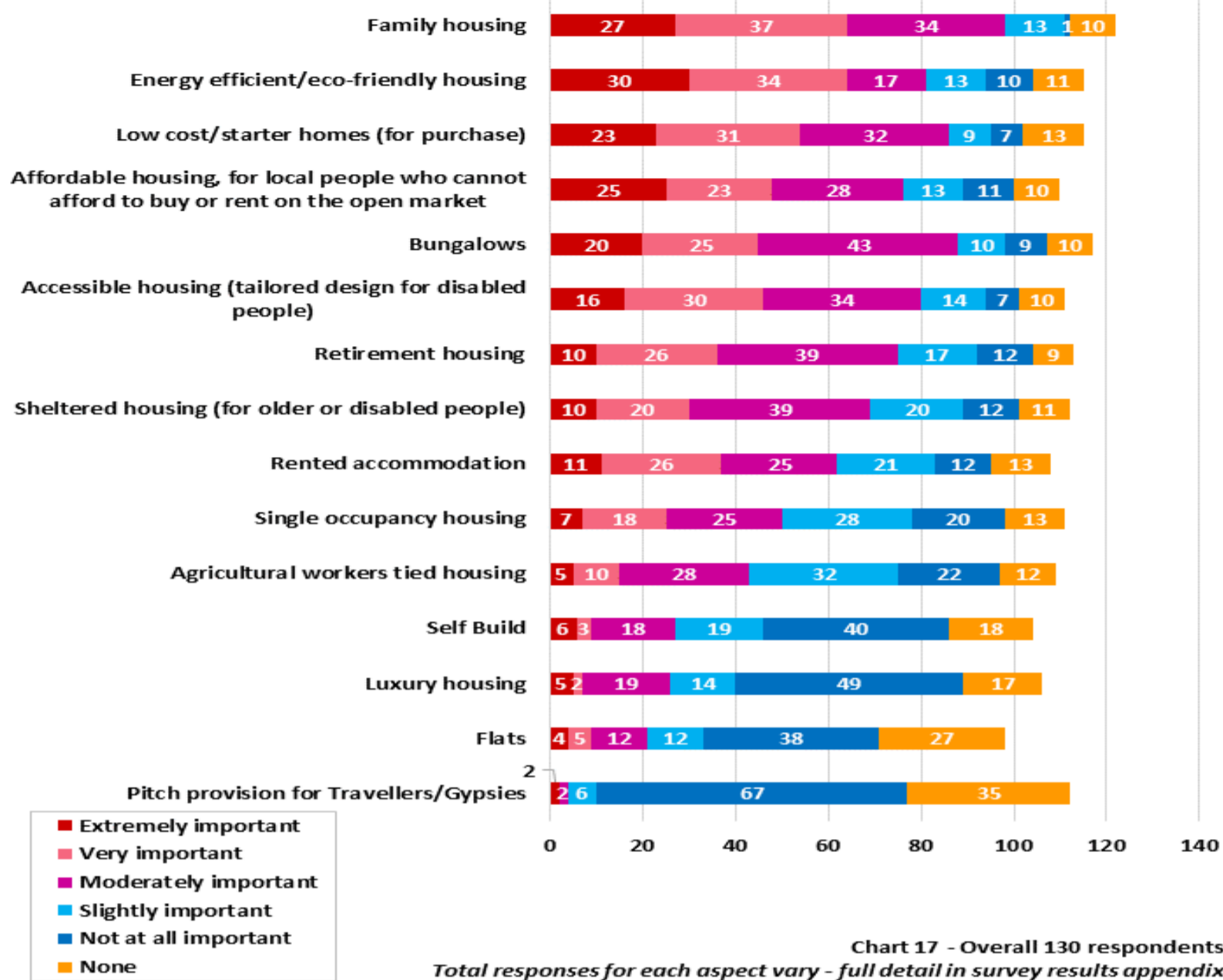

Housing



If Taunton Deane Borough Council policies proposed new housing for Oake Parish, what kind of new housing do you think would be most important for the Parish?



Just over 9 in 10 provided their view on this question (93%). The majority feel the Parish would be in most need of **family housing** (52%) and **energy efficient/eco-friendly housing**. Low cost starter homes for purchase are also considered important by nearly half the respondents. While around 2 in 5 feel that affordable housing for local people who can't afford open market housing, bungalows and accessible housing tailored for disabled people would also be important for the future housing mix in the Parish.

Luxury housing, flats and pitch provision for Travellers/Gypsies appear to be considered in plentiful supply by most respondents.

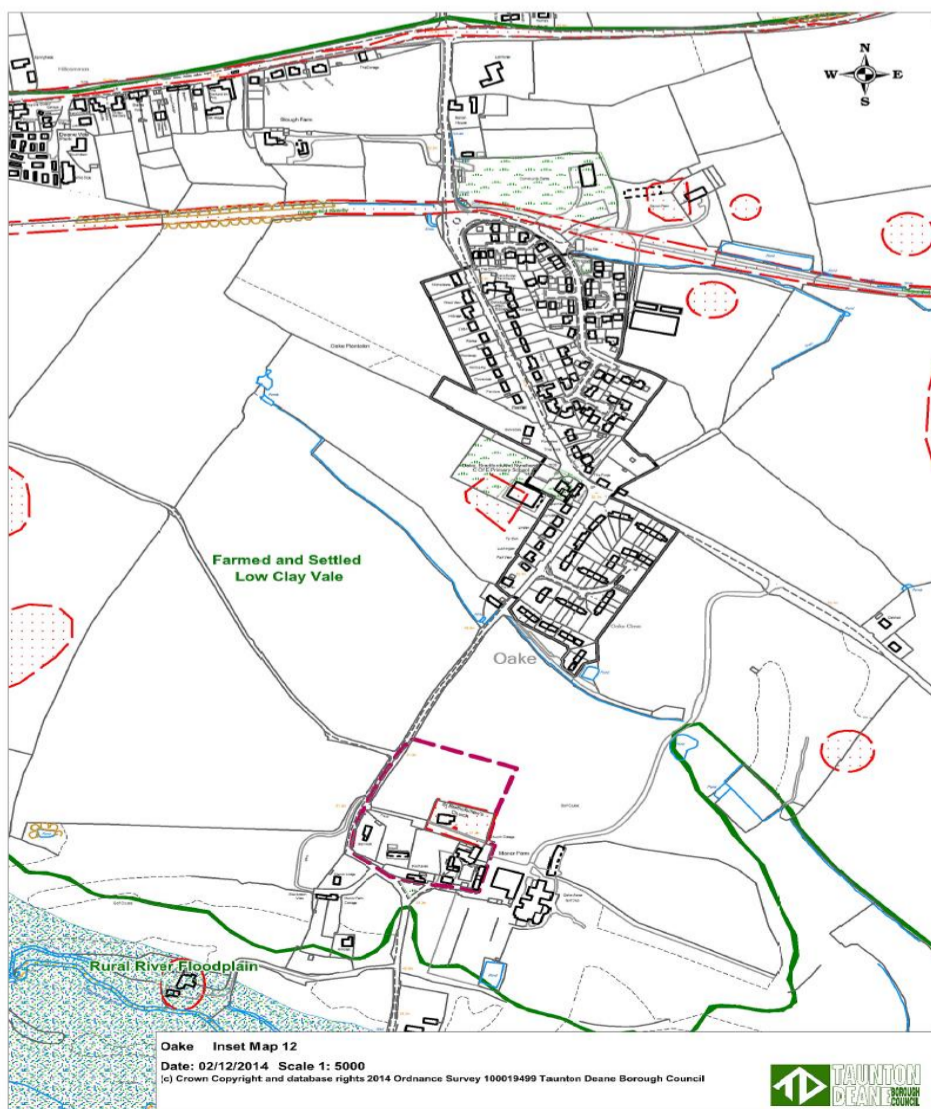

Taunton Deane Adopted Core Strategy and Draft Site Allocations and Development Management Plan Policies

Inset Maps Key

- Taunton Deane District Boundary
- Settlement Limits SP1, SB1
- Inset Map Area
- Housing Policy Land Allocation TA10, TA11, TA15, TA17, TA18, TA19, MA11, MA12, MA14, MN1, MN2, MN3, MN4, MN5, MN6, MN7, MN8
- Employment Land Allocations S55, TA6, TAU10, MA13
- Mixed Use Allocation S51, S52, S53, S54, TAU1, TAU2, WEL1
- Proposed Road S51, TAU1, TAU2, TAU4, MA11
- Area Reserved for Green Spaces S51, S52, S53, S54
- Mineral Consultation Area CP8 (also covered by Somerset County Council's Policy SMP9, Safeguarding)
- Waste Core Strategy Zones
- Conservation Areas CP8
- Green Wedge CP8
- Primary Shopping Frontage TC1
- Primary Shopping Area TC4, TC5
- Secondary Shopping Frontage TC2
- Proposed Cycle Routes CP6, S51, A3
- Town Centre Boundary CP5, A1, TC5
- Reserved Land for Educational Purpose S51, S52, S53, S54, CP7, C1, TAU1, TAU2
- Recreation and Tourism Allocation MA15
- Proposed Sewage Works Extension WEL2
- Bat Consultation Zone Hestercombe House SAC CP8
- Bat Consultation Zone Quarrick Hills SAC CP8
- Recreational Space CP8, C2
- Proposed Recreational Space TAU11, TAU12, MAU1, C3
- Existing and Proposed Local Shopping Centre CP3, S51, S52, S53, S54, TC3, TAU1, TAU2
- Area of High Archaeological Potential CP8, ENV4
- Scheduled Monument CP8, ENV4
- County Archaeological Sites CP8, ENV4
- Water Source Protection Zone CP1, CP8
- Local Geological Sites CP8
- Local Wildlife Sites CP8
- Social Protection Areas / Ramsar Site CP8
- Apical Area of Conservation
- Site of Special Scientific Interest CP8
- Special Landscape Features CP8, ENV3
- Park and Garden of Special Historical Interest CP8, ENV1
- Landscape Character Area CP8
- Area of Outstanding Natural Beauty CP8
- Country Park S51, S52
- Flood Zone 3b CP8
- Flood Zone 3a CP8
- Flood Zone 2 CP8